

# TiLite **TWIST** Order Form

Effective March 14, 2016 (New Items in Red)

ALUMINUM RIGID, GROWABLE FRAME

Page 1 of 6

DEALER INFORMATION		RTS INFORMATION	
Dealer:	Account #:	RTS:	Phone:
PO:	Ordered By:	Email:	
Email:		SHIP TO INFORMATION	
Mark For:		Name:	Ship Via:
TiLite Sales Rep:		Address:	
TiLite Information:	Promo Code:	City:	State: Zip:
Ship Date:	Order #:	Phone:	Fax:

Please Email or Fax to the TiLite Customer Service Team at [orders@tilite.com](mailto:orders@tilite.com) or 866.586.2413 / 509.586.2413

## FRAME STYLE

TWFS2 ☐ TiLite Twist (Full Adjustability. Seat Width **A** Grows 2" and Seat Depth **B** Grows 3". 165 Pound Weight Limit.).....\$2,675 E1235  
 TWFSW7 ☐ Abduction Frame with 2" Outward Flare.....\$155

## FRAME FINISHES

<b>High Gloss Paint</b>	TWFF8 <input type="checkbox"/> Super Wet Black	TWFF10 <input type="checkbox"/> TiLite Red
	TWFF29 <input type="checkbox"/> Neon Pink	<b>TWFF35 <input type="checkbox"/> Burgundy</b>
<b>Metallic Paint</b>	TWFF14 <input type="checkbox"/> Ocean Blue Metallic	TWFF15 <input type="checkbox"/> Tangerine Metallic
	TWFF16 <input type="checkbox"/> Salsa Red Metallic	TWFF30 <input type="checkbox"/> Acid Green Metallic
<b>Pearlescent Paint</b>	TWFF17 <input type="checkbox"/> Midnight Blue Pearl	TWFF18 <input type="checkbox"/> White Pearl
<b>Matte Paint</b>	TWFF19 <input type="checkbox"/> Black Lava	TWFF20 <input type="checkbox"/> Deep Blue Ice
	TWFF27 <input type="checkbox"/> Titanium Grey	
<b>Candy Paint</b>	TWFF22 <input type="checkbox"/> Ruby Red	TWFF23 <input type="checkbox"/> Azure Blue
	TWFF25 <input type="checkbox"/> Electric Plum.....	STD

## COLOR ANODIZE PACKAGE

(Color Anodize Package includes: Camber Mount, Caster Mount, Caster Fork, Caster Cap and Footrest Clamp. If no anodize color is selected, the default will be black.)

TWANO1 ☐ Black .....STD  
 TWANO5 ☐ Sapphire TWANO3 ☐ Red Pepper TWANO6 ☐ Burnt Orange  
 TWANO8 ☐ Ultraviolet **TWANO9 ☐ Fuschia**.....\$160

## TRANSIT TIE-DOWN OPTION

(Please refer to the Twist Transit Tie-Down Option Brochure for important information regarding the Transit Tie-Down Options.)

TWTTDO ☐ Transit Tie-Down Option (Consists of four Tie-Down Brackets.).....\$205

## FRAME MEASUREMENTS

**SEAT WIDTH **A**** Measure from outside of seat tube at back post to the outside of the opposite seat tube at back post. Seat Width grows 2". All upholstery (except cushion) and components (except TiShaft Back Release Bar available at no charge upon request) needed to grow the Twist seat width are included.

TWSW5 ☐ 8"-10" ☐ 9"-11" ☐ 10"-12" ☐ 11"-13" ☐ 12"-14" ☐ 13"-15".....STD  
 Default will be smallest Seat Width for selected range. Please use "Set at" f or Seat Width other than default. Set at \_\_\_\_\_ (Use 1" increments)

**SEAT DEPTH **B**** Measure from front of back post to the front edge of seat sling. Front edge of seat sling will be 1.5" from the beginning of the bend on No Taper and Tapered Frames, and 2" from the beginning of the bend on Abduction Frames. All Upholstery (except cushion) and components needed to grow the Twist seat depth are included. Seat Depth grows 3".

TWSD4 ☐ 8"-11" (Requires either 18" or 20" Rear Wheels.) ☐ 9"-12" ☐ 10"-13" ☐ 11"-14" ☐ 12"-15" ☐ 13"-16".....STD  
 Default will be shortest Seat Depth for selected range. Please use "Set at" for Seat Depth other than default. Set at \_\_\_\_\_ (Use 1" increments)

**FRONT SEAT HEIGHT **C**** Measure from floor to top of seat tube at front edge of seat sling. Twist adjusts up and down in 1/2" increments. (2" Taper available with 12" - 15" or 13" - 16" Seat Depths **B** only. For 2" Taper Footrest width **1** add 1.5" to minimum Front Seat Height.)

TWFSH1 ☐ 13" ☐ 13.5" ☐ 14" ☐ 14.5" ☐ 15" ☐ 15.5" ☐ 16" ☐ 16.5" ☐ 17" ☐ 17.5" ☐ 18" ☐ 18.5" ☐ 19" ☐ 19.5" ☐ 20" ☐ 20.5" ☐ 21" ☐ 21.5".....STD

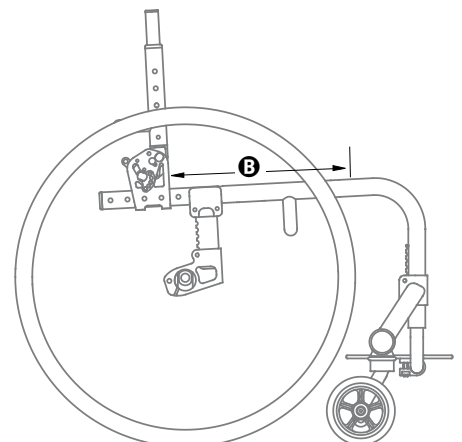
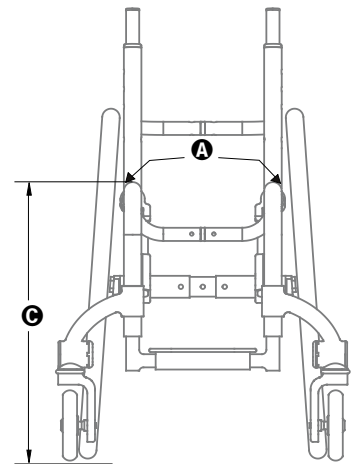
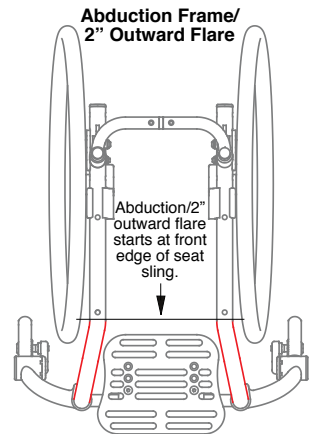

tilite.com  
 2701 West Court Street | Pasco, Washington 99301  
 509.586.6117 Tel | 800.545.2266 Toll-Free  
 509.586.2413 Fax | 866.586.2413 Toll-Free Fax

TiLite® OF0009\_TWIST\_0316RevAF

# TiLite **TWIST** Order Form

Effective March 14, 2016 (New Items in Red)

ALUMINUM RIGID, GROWABLE FRAME

Page 2 of 6

## FRAME MEASUREMENTS

### FRONT SEAT HEIGHT ③ RANGES

Front Wheel Size	Front Seat Heights for 8"-11" Seat Depth ③	Front Seat Heights for 9"-12" Seat Depth ③	Front Seat Heights for 10"-13" Seat Depth ③	Front Seat Heights for 11"-14" Seat Depth ③	Front Seat Heights for 12"-15" Seat Depth ③	Front Seat Heights for 13"-16" Seat Depth ③
3"	13.0" - 14.5"	13.5" - 15.0"	13.0" - 16.0"	14.0" - 17.0"	14.5" - 17.5"	15.5" - 18.5"
3" Glide™	14.5" - 15.5"	15.0" - 16.5"	14.0" - 17.0"	15.0" - 18.0"	16.0" - 19.0"	16.5" - 19.5"
4"	13.5" - 15.0"	14.0" - 15.5"	13.5" - 16.5"	14.0" - 17.5"	15.0" - 18.0"	16.0" - 18.5"
4" Glide™	14.5" - 16.0"	15.5" - 17.0"	14.5" - 17.5"	15.5" - 18.5"	16.0" - 19.0"	17.0" - 20.0"
5"	N/A	N/A	14.0" - 17.0"	14.5" - 17.5"	15.5" - 18.5"	16.5" - 19.5"
5" Glide™	N/A	N/A	N/A	N/A	N/A	N/A

**REAR SEAT HEIGHT ④** Measure from floor to top of seat tube at Back Post. Twist adjusts up and down in 1/2" increments.

### REAR SEAT HEIGHT RANGES

Rear Wheel Size	Rear Seat Heights ④					
18"	12" - 17"	TWRSH1	<input type="checkbox"/> 12"	<input type="checkbox"/> 12.5"	<input type="checkbox"/> 13"	<input type="checkbox"/> 13.5"
20"	13" - 17.5"		<input type="checkbox"/> 14"	<input type="checkbox"/> 14.5"	<input type="checkbox"/> 15"	<input type="checkbox"/> 15.5"
22"	14" - 18.5"		<input type="checkbox"/> 16"	<input type="checkbox"/> 16.5"	<input type="checkbox"/> 17"	<input type="checkbox"/> 17.5"
24"	15" - 19.5"		<input type="checkbox"/> 18"	<input type="checkbox"/> 18.5"	<input type="checkbox"/> 19"	<input type="checkbox"/> 19.5".....STD

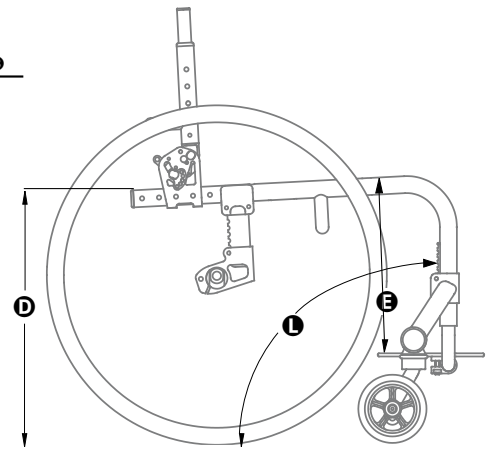

**FRONT ANGLE ①** Measure from frame front to floor.

TWFA1 ☐ 70° ☐ 80° ☐ 90°.....STD

**SEAT TO FOOTREST ③/FOOTRESTS** Measure from front edge of seat sling to top rear of footrest.

**Standard Footrests** Measurement must be at least 2" shorter than Front Seat Height ③.

☐ 9" ☐ 9.5" ☐ 10" ☐ 10.5" ☐ 11" ☐ 11.5" ☐ 12" ☐ 12.5" ☐ 13" ☐ 13.5" ☐ 14" ☐ 14.5" ☐ 15" ☐ 15.5" ☐ 16" ☐ 16.5" ☐ 17" ☐ 17.5" ☐ 18" ☐ 18.5" ☐ 19"

TWFR3 ☐ Angle Adjustable Footrest.....STD

TWFR24 ☐ Flip-Back Depth & Angle Adjustable Footrest (Not available when both 13" - 15" Seat Width ⑤ and Abduction

Frame/2" Outward Flare are ordered.).....\$200 K0040

**High Mount Footrests**

☐ 5" ☐ 5.5" ☐ 6" ☐ 6.5" ☐ 7" ☐ 7.5" ☐ 8" ☐ 8.5" ☐ 9" ☐ 9.5" ☐ 10" ☐ 10.5" ☐ 11" ☐ 11.5" ☐ 12" ☐ 12.5" ☐ 13" ☐ 13.5" ☐ 14"

TWFR4 ☐ Angle Adjustable High Mount Footrest.....\$90 K0040

TWFR27 ☐ Flip-Back Depth & Angle Adjustable High Mount Footrest (Not available when both 13" - 15" (33-38cm) Seat Width ⑤ and Abduction Frame with 2" Outward Flare are ordered.).....\$290 K0040, K0045

### SEAT TO FOOTREST ③ RANGES (2" Taper available with 12" - 15" or 13" - 16"

Seat Depths ③ only. Add 1.5" to minimum Seat to Footrest ③ Ranges with 2" Taper.)

	3" Front Wheel		4" Front Wheel		5" Front Wheel	
Seat Depth ③	Standard Footrest	High Mount Footrest	Standard Footrest	High Mount Footrest	Standard Footrest	High Mount Footrest
8" - 11"	9.0" - 12.0"	5.0" - 8.0"	9.0" - 12.0"	5.0" - 8.0"	N/A	N/A
9" - 12"	10.0" - 13.0"	6.0" - 9.0"	10.0" - 13.0"	6.0" - 9.0"	N/A	N/A
10" - 13"	9.0" - 13.5"	5.0" - 9.5"	9.0" - 13.5"	5.0" - 9.5"	9.0" - 14.0"	5.0" - 10.0"
11" - 14"	10.0" - 14.5"	6.0" - 10.5"	10.0" - 14.5"	7.0" - 11.5"	10.0" - 15.0"	6.0" - 11.0"
12" - 15"	11.0" - 15.0"	7.0" - 11.5"	11.0" - 15.0"	8.0" - 12.5"	11.0" - 15.5"	7.0" - 12.0"
13" - 16"	12.0" - 16.0"	8.0" - 12.5"	12.0" - 16.0"	7.5" - 12.0"	12.0" - 16.5"	8.0" - 13.0"

**FOOTREST WIDTH ①** Select one of the following options: No Taper or 2" Taper. Measure from inside of front frame tube to inside of opposite front frame tube.

TWFSW1 ☐ No Taper (2" Narrower than Seat Width ⑤).....STD

TWFSW4 ☐ 2" Taper (4" Narrower than Seat Width ⑤. Available with 12" - 15" or 13" - 16" Seat Depths ③ only. Add 1.5" to minimum

Seat to Footrest ③ Ranges.).....NCO

### FOOTREST WIDTH ① (Inside Measurement)

SEAT WIDTH ⑤ (Outside Measurement)	No Taper (2" Narrower than Seat Width ⑤)	2" Taper (4" Narrower than Seat Width ⑤)
8"	6"	N/A
9"	7"	N/A
10"	8"	N/A
11"	9"	N/A
12"	10"	8"
13"	11"	9"
14"	12"	10"
15"	13"	11"

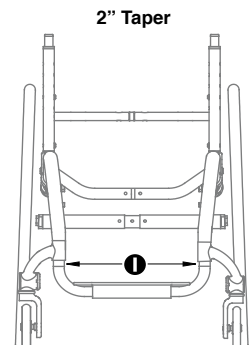

## FRAME MEASUREMENTS

**SEAT BACK TYPE/PUSH HANDLES/SEAT BACK HEIGHT** **F** Measure from top of back post to top of seat tube at rear of frame.

### SEAT BACK TYPE

- TWSB1 ☐ Folding Aluminum Adjustable Height with TiShaft Aluminum Back Release Bar.....**STD**  
 TWSB11 ☐ Seat Back that Locks when Folded.....**NCO**

### PUSH HANDLES

- TWSB6 ☐ Integrated Push Handles.....**NCO**  
 TWSB7 ☐ Integrated Fold-Down Push Handles (Requires Tension Adjustable by Straps Back Upholstery.).....**\$105**  
 TWSB8 ☐ Bolt-On Push Handles (Requires 12"-14" or 13"-15" Seat Width **A** range.).....**\$185**  
 TWSB9 ☐ Bolt-On Height-Adjustable Push Handles (Requires 12"-14" or 13"-15" Seat Width **A** range.).....**\$315**  
 TWSB20 Bolt-On Center Mount Height-Adjustable Push Handle  
     ☐ Small 9.25"   ☐ Standard 14.25"   ☐ Tall 19.25".....**\$170**  
 TWSB21 ☐ Stroller Handle.....**\$205**

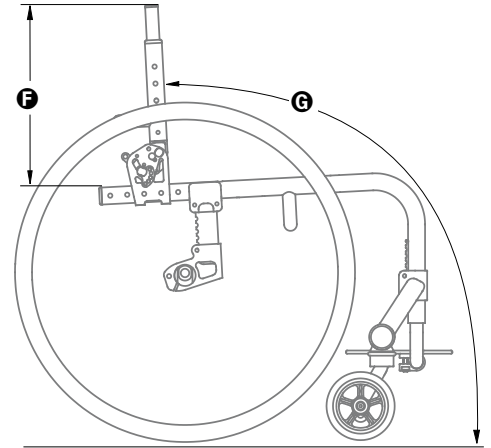

**SEAT BACK HEIGHT** **F** (Short Seat Back Height **F** not available with Flip Back Tubular Armrests. Tall Seat Back Height **F** not available with Seat Widths **A** of 11"-13" or smaller.)

Push Handles (Selected Above)	Short	Medium	Tall	Set at: (Use 1/2" increments)
None/Bolt-On/Stroller	<input type="checkbox"/> 8.5"- 11.5"	<input type="checkbox"/> 12"- 16.5"	<input type="checkbox"/> 16.5"- 20.5"	Set at: _____
Integrated	<input type="checkbox"/> 10.5"- 12.5"	<input type="checkbox"/> 13.5"- 16.5"	<input type="checkbox"/> 17.5"- 20.5"	Set at: _____
Integrated Fold-Down	<input type="checkbox"/> 13"- 15.5"	<input type="checkbox"/> 14.5"- 19"	<input type="checkbox"/> 18.5"- 21"	Set at: _____

## AVAILABLE ON ALL BACKS

- TWSB22 ☐ Height Adjustable Backrest Rigidizer Bar.....**\$145**

**SEAT BACK ANGLE** **G** Measure angle from front of back post to floor. 90° will be perpendicular to the floor. To approximate the angle from the back post to the seat, subtract 2 degrees from measurement **G** for every 1/2" of dump.

- TWSBA1 ☐ 80°   ☐ 83°   ☐ 86°   ☐ 89°   ☐ 92°   ☐ 95°   ☐ 98°   ☐ 101°.....**NCO**

**REAR WHEEL SPACING** **I** Measure from outside of seat back post to inside of rear tire. 3/4" Rear Wheel Spacing not available with 0° or 2° Camber **K**. Not all rear wheel spacing is available with all accessories.

- TWRWS1 ☐ .75"   ☐ 1"   ☐ 1.25"   ☐ 1.5"   ☐ 1.75"   ☐ 2".....**STD**  
 TWCBR12 ☐ Adjustable Rear Wheel Spacing Camber Plugs.....**STD**  
 TWCBR9 ☐ Additional Spacers to Increase Rear Wheel Spacing.....**NCO**

## CAMBER **K**/CAMBER TUBES

- TWCBR1 ☐ 0°   ☐ 2°   ☐ 4°   ☐ 6°   ☐ 8°   ☐ 12°.....**STD**  
 TWCBR15 ☐ Aluminum Camber Tube.....**STD**

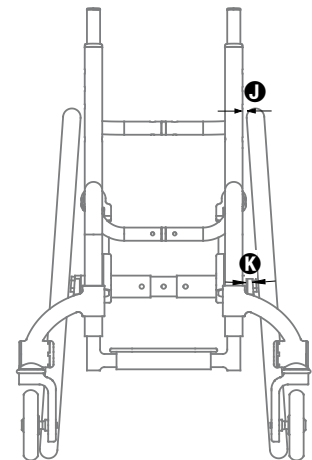

## CUSTOM CONFIGURATION OPTIONS

**FRONT WHEELS** (See Front Seat Height Ranges Chart on Page 2 for Front Seat Height **G** limitations.)

- TWFW24 ☐ 3"x1.5" LiteSpeed Billet Aluminum Wheel w/Soft Roll Tire   ☐ Silver Hub   **OR**   ☐ Black Hub.....**\$175**  
 TWFW14 ☐ 4"x.75" Plastic Wheel w/Poly Tire (Not available with Slipstream Fork or Glide™ Single-Sided Fork.).....**NCO**  
 TWFW3 ☐ 4"x.75" Light-Up Micro-Caster (Not available with Slipstream Fork or Glide™ Single-Sided Fork.).....**\$75**  
 TWFW25 ☐ 4"x.75" LiteSpeed Billet Aluminum Wheel w/Poly Tire   ☐ Silver Hub   **OR**   ☐ Black Hub.....**\$135**  
 TFFW26 ☐ 4"x1.5" LiteSpeed Plastic Wheel w/Soft Roll Tire (Not available with Power Assist, Power Add-on System or Heavy Duty Frame.).....**\$85**  
 TWFW27 ☐ 4"x1.5" LiteSpeed Billet Aluminum Wheel w/Soft Roll Tire   ☐ Silver Hub   **OR**   ☐ Black Hub.....**\$185**  
 TWFW6 ☐ 5"x1" Plastic Wheel w/Poly Tire (Not available with 90° Front Angle **L**, Slipstream Fork or Glide™ Single-Sided Fork.).....**NCO**  
 TWFW28 ☐ 5"x1.5" LiteSpeed Plastic Wheel w/Soft Roll Tire (Not available with 90° Front Angle **L**.).....**\$85**  
 TWFW29 ☐ 5"x.75" LiteSpeed Billet Aluminum Wheel w/Poly Tire   ☐ Silver Hub   **OR**   ☐ Black Hub  
     (Not available with 90° Front Angle **L**.).....**\$155**  
 TWFW30 ☐ 5"x1.5" LiteSpeed Billet Aluminum Wheel w/Soft Roll Tire   ☐ Silver Hub   **OR**   ☐ Black Hub  
     (Not available with 90° Front Angle **L**.).....**\$200**

## FRONT FORKS

- TWFK1 ☐ TiLite Standard Fork.....**STD**  
 TWFK2 ☐ TiLite Slipstream Single-Sided Fork.....**\$160**  
 TWGL1 ☐ Out-Front Glide™ Suspension Fork (Black anodize only. Requires 14.5" minimum Front Seat Height **G**.).....**\$455**   **E1015**  
     Rider's Weight:   ☐ 125 lbs.   ☐ 125-180 lbs.  
 TWGL2 ☐ Out-Front Glide™ Single-Sided Suspension Fork (Black anodize only. Requires 14.5" minimum Front Seat Height **G**.).....**\$585**   **E1015**  
     Rider's Weight:   ☐ 125 lbs.   ☐ 125-180 lbs.  
 TWTS1 ☐ Titanium Fork Stem.....**\$55**

# TiLite **TWIST** Order Form

Effective March 14, 2016 (New Items in Red)

ALUMINUM RIGID, GROWABLE FRAME

Page 4 of 6

## CUSTOM CONFIGURATION OPTIONS

### REAR WHEELS (See Rear Seat Height Ranges Chart on Page 2 for Rear Seat Height Ⓟ limitations.)

TWRW14 TiLite SHADOW™	STD
<input type="checkbox"/> 18"(400)	
<input type="checkbox"/> 20"(451)	
<input type="checkbox"/> 22"(501)	
<input type="checkbox"/> 24"(540)	
TWRW7 Spinergy SPOX <input type="checkbox"/> Black <input type="checkbox"/> Red <input type="checkbox"/> Yellow <input type="checkbox"/> Blue <input type="checkbox"/> White	\$795
<input type="checkbox"/> 22"(501) - Std. Hub	
<input type="checkbox"/> 24"(540) - Std. Hub	
TWRW8 Spinergy LX <input type="checkbox"/> Black <input type="checkbox"/> Red <input type="checkbox"/> Yellow <input type="checkbox"/> Blue <input type="checkbox"/> White <input type="checkbox"/> Go Green <input type="checkbox"/> Bright Orange <input type="checkbox"/> Flamingo Pink	\$995
<input type="checkbox"/> 22"(501) - Std. Hub	
<input type="checkbox"/> 24"(540) - Std. Hub	
TWRW16 Spinergy Carbon Blade	\$1,395
<input type="checkbox"/> 24"(540)	
TWRW17 X-Core Mag (Not available with Short Tabs, Quad Release Axles or Spoke Guards. Available with Aluminum Sliver Anodized Handrims only.)	\$55
<input type="checkbox"/> 20"(451)	
<input type="checkbox"/> 22"(501)	
<input type="checkbox"/> 24"(540)	

### AXLES

TWAXL1 <input type="checkbox"/> Stainless Quick Release	STD
TWAXL2 <input type="checkbox"/> Titanium Quick Release	\$240
TWAXL3 <input type="checkbox"/> Quad Release (Not available with Mag Rear Wheels.)	\$145

### PNEUMATIC REAR TIRES

TWRTR1 <input type="checkbox"/> Treaded (20" (451) Mag Wheels require Airless Inserts.)	STD
TWRTR2 <input type="checkbox"/> Airless Inserts (Not available with 18" Rear Wheels or Topolino Rear Wheels.)	\$85 E2213
TWRTR4 <input type="checkbox"/> Primo (Not available with 18" Rear Wheels or Mag Rear Wheels.)	NCO
TWRTR8 <input type="checkbox"/> 24"(540) Schwalbe® Marathon Plus Evolution (Not available with Mag Rear Wheels.)	\$130
TWRTR9 <input type="checkbox"/> 24"(540) Schwalbe® Slick Tires (Not available with Mag Rear Wheels.)	\$135
TWRTR24 <input type="checkbox"/> 24"(540) Kenda Kobra Knobby Tires	\$80

### SOLID REAR TIRES

TWRTR22 <input type="checkbox"/> 18"(400), 20"(451), 22"(501) and 24"(540) Primo Express	\$100
TWRTR23 <input type="checkbox"/> 24"(540) Primo Active	\$125

### HANDRIMS

#### Handrims by OUT-FRONT®

TWRIM1 <input type="checkbox"/> Aluminum – Silver Anodized	STD
TWRIM21 <input type="checkbox"/> Aluminum – Black Anodized (Not available with Mag, 18" (400), or 20" (451) Rear Wheels.)	NCO
TWRIM12 <input type="checkbox"/> Titanium – Satin Finish (Not available with Mag, 20"(451) or 22"(501) Rear Wheels, or 24"(540) Knobby tires.)	\$430
The Natural-Fit® (Original, Larger Profile) (Not available with Mag, 18"(400) or 20"(451) Rear Wheels.)	
TWRIM14 <input type="checkbox"/> Standard Grip (Not available with Short Tabs or Spinergy Carbon Blade Rear Wheels.)	\$360
TWRIM15 <input type="checkbox"/> Super Grip (Not available with Short Tabs or Spinergy Carbon Blade Rear Wheels.)	\$405
TWRIM 16 <input type="checkbox"/> Without Thumb Grip	\$335
The Natural-Fit® LT (Reduced Weight, Smaller Profile) (Not available with Mag, 18"(400) or 20"(451) Rear Wheels.)	
TWRIM17 <input type="checkbox"/> Standard Grip (Not available with Short Tabs or Spinergy Carbon Blade Rear Wheels.)	\$390
TWRIM18 <input type="checkbox"/> Super Grip (Not available with Short Tabs or Spinergy Carbon Blade Rear Wheels.)	\$440
TWRIM19 <input type="checkbox"/> Without Thumb Grip	\$365
TWRIM10 <input type="checkbox"/> The Surge (All-In-One Oval with Gription™ Strip, Larger Profile) (Not available with Mag, 18"(400) or 20"(451) Rear Wheels.)	\$375
TWRIM11 <input type="checkbox"/> The Surge LT (All-In-One Oval with Gription™ Strip, Smaller Profile) (Not available with Mag, 18"(400) or 20"(451) Rear Wheels.)	\$405
TWRIM20 <input type="checkbox"/> Q-Grip (Exclusive High-Friction, Anti-Slip Coating) (Not available with 18"(400), 20"(451) or Mag Rear Wheels.)	\$315
TWRIM21 <input type="checkbox"/> Omit Handrims	NCO

#### Tab Length

TWRIM7 <input type="checkbox"/> Long Tabs	STD
TWRIM8 <input type="checkbox"/> Short Tabs (Not available with Mag Rear Wheels or The Natural-Fit® Handrims with Thumb Grip.)	\$20

### WHEEL LOCKS

#### Wheel Locks by OUT-FRONT®

TWWLK7 <input type="checkbox"/> Compact Composite Push to Lock (Available with .75" to 1.5" Rear Wheel Spacing Ⓢ only.)	NCO
TWWLK8 <input type="checkbox"/> Compact Composite Pull to Lock (Available with .75" to 1.5" Rear Wheel Spacing Ⓢ only.)	NCO
TWWLK10 <input type="checkbox"/> Extension Handles for Composite Push/Pull to Lock	\$80 E0961
TWWLK9 <input type="checkbox"/> Composite Scissor Lock	\$135

#### Additional Wheel Locks

TWWLK3 Uni-Lock Set At: <input type="checkbox"/> Push <b>OR</b> <input type="checkbox"/> Pull	\$155
TWWLK4 <input type="checkbox"/> Extension Handles for Uni-Lock	\$80 E0961

# TiLite **TWIST** Order Form

Effective March 14, 2016 (New Items in Red)

ALUMINUM RIGID, GROWABLE FRAME

Page 5 of 6

## CUSTOM CONFIGURATION OPTIONS

### BACK UPHOLSTERY (Want more seating options? [Click here](#) to view the new TiLite Seating Order Form.)

TWBUP2 <input type="checkbox"/> Velcro Adjustable (Not available with Fold-Down Push Handles.)	STD	
Tension Adjustable by Straps (Required with Fold-Down Push Handles.)		
TWBUP3 <input type="checkbox"/> Padded Nylon	\$320	E2611
TWBUP5 <input type="checkbox"/> AIR Breathable Upholstery (Not available with Ultrasuede or NiteLite Backrest Stripe.)	\$320	E2231
TWUPC3 Ultrasuede Backrest Stripe <input type="checkbox"/> Black <input type="checkbox"/> Sapphire <input type="checkbox"/> Red Pepper <input type="checkbox"/> Burnt Orange <input type="checkbox"/> Ultraviolet		
<input type="checkbox"/> NiteLite Reflective (Not available with AIR Breathable Back Upholstery.)	\$95	
TWBUP0 <input type="checkbox"/> Omit Back Upholstery	NCO	

### SEAT UPHOLSTERY

TWSUP1 <input type="checkbox"/> Tension Adjustable Bolt On (Black only.)	STD	
TWSUP0 <input type="checkbox"/> Omit Seat Upholstery	NCO	

### SEAT CUSHION (Want more seating options? [Click here](#) to view the new TiLite Seating Order Form.)

TWCSH1 Foam Cushion <input type="checkbox"/> 2" <input type="checkbox"/> 3" <input type="checkbox"/> 4"	\$105	
---	-------	--

### SIDE GUARDS

TWSDG1 <input type="checkbox"/> Cloth	\$90	
<b>Aluminum</b>		
TWSDG2 <input type="checkbox"/> Rigid Removable <input type="checkbox"/> Xtra Small <b>OR</b> <input type="checkbox"/> Small <b>OR</b> <input type="checkbox"/> Std	\$185	
TWSDG3 <input type="checkbox"/> Quad Removable w/Hole <input type="checkbox"/> Small <b>OR</b> <input type="checkbox"/> Std	\$200	
<b>Carbon Fiber</b>		
TWSDG7 <input type="checkbox"/> Rigid Removable <input type="checkbox"/> Small <b>OR</b> <input type="checkbox"/> Std	\$290	
TWSDG8 <input type="checkbox"/> Quad Removable w/Hole <input type="checkbox"/> Small <b>OR</b> <input type="checkbox"/> Std	\$300	
TWSDG12 <input type="checkbox"/> Fendered Removable	\$425	
<b>Available on Aluminum and Carbon Fiber Non-Fendered Side Guards</b>		
TWSDG13 <input type="checkbox"/> Side Guards Custom Cut to Profile of Rear Wheels (Not available with Cloth.)	\$295	

### ARMRESTS (Desk Arms come with built-in Side Guards.)

TWARM1 <input type="checkbox"/> Swing Away Tubular	\$210	E0973
TWARM4 <input type="checkbox"/> Flip Back Tubular (Requires Tension Adjustable by Straps Back Upholstery. Not available with Short Seat Back Height ②.)	\$295	E0973
TWARM2 <input type="checkbox"/> Removable Height Adjustable Pediatric Desk Arm with Rigid Side Guard (Requires 10" minimum Seat Depth ③.)	\$315	E0973
<input type="checkbox"/> Standard Length Pad (10")		
<b>Available Armrest Option</b>		
TWARM5 <input type="checkbox"/> Covered in Black Ultrasuede (Not available with Desk Arms)	\$100	

### SEAT BELTS

TWBLT1 <input type="checkbox"/> Velcro Adjustable, Black Nylon Webbing	\$50	E0978
TWBLT2 <input type="checkbox"/> Bodypoint® 2" Push-Button Buckle (Auto-Style.)	\$90	E0978
TWBLT4 <input type="checkbox"/> Bodypoint® 1" Wide Push-Button Buckle Padded (Auto-Style.)	\$175	E0978
TWBLT5 <input type="checkbox"/> Bodypoint® 1.5" Wide Push-Button Buckle Padded (Auto-Style.)	\$165	E0978
TWBLT10 <input type="checkbox"/> Bodypoint® Optional Band Clamp Mounting Hardware	\$20	E0978

### CALF STRAP

TWCLF2 Velcro Adjustable	\$35	K0038
<input type="checkbox"/> Xtra Small (Recommended for 6"- 9" Footrest Widths.)		
<input type="checkbox"/> Small (Recommended for 9"- 12" Footrest Widths.)		
<input type="checkbox"/> Medium (Recommended for 11"- 15" Footrest Widths.)		
TWCLF3 Bodypoint® Padded Velcro Adjustable	\$95	K0038
<input type="checkbox"/> Small (Recommended for 8"- 11" Footrest Widths.)		
<input type="checkbox"/> Medium (Recommended for 12"- 15" Footrest Widths.)		
TWCLF1 <input type="checkbox"/> Buckle Adjustable, Black Nylon Webbing	\$25	K0038

### BACK PACK

TWBCK3 <input type="checkbox"/> Black TiLite Back Pack	\$85	
--	------	--

### SEAT POUCH

TWPC3 <input type="checkbox"/> Black TiLite Seat Pouch	\$55	
--	------	--

### SPOKE GUARDS by SPOZEE.COM

TWGRD1 <input type="checkbox"/> Clear with TiMotion Logo (Not available with Mag Rear Wheels or 18" Rear Wheels.)	\$125	K0065
---	-------	-------

### ANTI-TIPS

TWTIP1 <input type="checkbox"/> Rear Aluminum - Black (Seat Widths ④ of 8" to 10", 9" to 11" or 10" to 12" will ship with the Center Mount Single Non-Swivel Caster (TWTIP6) at no additional cost when Black Aluminum (TWTIP1) is selected.)	\$150	E0971
TWTIP2 <input type="checkbox"/> User Friendly Flip-up (Requires 12" to 14" or 13" to 15" Seat Widths ④ range.)	\$315	E0971
TWTIP5 <input type="checkbox"/> Center Mount Swivel Caster Anti-Tip	\$240	E0971
TWTIP6 <input type="checkbox"/> Center Mount Non-Swivel Caster Anti-Tip	\$215	E0971



# TiLite **TWIST** Order Form

Effective March 14, 2016 (New Items in Red)

ALUMINUM RIGID, GROWABLE FRAME

Page 6 of 6

## CUSTOM CONFIGURATION OPTIONS

### ACCESSORIES

TWUEST1 Upper Extremity Support Tray	<input type="checkbox"/> 12" to 14" OR <input type="checkbox"/> 13" to 15" Seat Widths <b>A</b> (Requires Armrests.)	\$270	E0950
TWGS1 <input type="checkbox"/> GRIP Solutions Lap Board		\$50	
TWMPCT2 Neoprene Impact Guards with Ultrasuede Stripe	<input type="checkbox"/> Black <input type="checkbox"/> Sapphire <input type="checkbox"/> Red Pepper <input type="checkbox"/> Burnt Orange		
	<input type="checkbox"/> Ultraviolet <input type="checkbox"/> TiLite NiteLite Reflective	\$95	
TWCH1 <input type="checkbox"/> Crutch Holder		\$210	E2207
TWHS1 <input type="checkbox"/> TiLite 9 Piece SAE Round Handle Folding Hex Key Set		\$25	
TWKBH1 TWIST Baseball Hat	<input type="checkbox"/> Dark Blue with Sapphire Stitching <input type="checkbox"/> Pink with Hot Pink Stitching	NCO	

## DESIGNS UNLIMITED

TiLite's TWIST offers millions of different frame combinations! But sometimes even that's not enough. If you would like to customize your TiLite, check out the Designs Unlimited Studio at [tilite.com](http://tilite.com). There you will find drawings and pricing for hundreds of creative solutions to customers' customization requests. We call these "D.U.'s." If you don't find the D.U. you're looking for, contact the TiLite Customer Service Team at 800.545.2266 or [customerservice@tilite.com](mailto:customerservice@tilite.com) and we'll design a D.U. just for you. Designs Unlimited customization may add an additional 2 to 3 weeks to the ship time of your chair.

## GENERAL

TiLite manufactures a wide variety of wheelchairs to meet the varied needs of wheelchair users. The final selection of a particular model, its options and accessories, and its measurements rests solely with the wheelchair user and advising healthcare professional. TiLite wheelchairs must be fitted by a qualified healthcare professional. HCPCS Codes are for reference purposes only. Actual coding and coverage varies by payer. Proper HCPCS coding is not a guarantee of payment. Please verify the appropriate payer's coverage policy.

**Get the latest order forms at [tilite.com](http://tilite.com).** Prices, standard features, options and accessories are subject to change without notice. All rights reserved. Trademarks are identified by symbols™ and ®. TiLite, TiFit, the TiLite logo, Ti, the Ti logo, The Titanium Experts, and TiShaft are registered trademarks of TiSport, LLC and are licensed to TiLite, LLC. Adobe®, Acrobat®, Acrobat Professional® and Reader® are registered trademarks of Adobe Systems Inc. Bodypoint® is a registered trademark of Bodypoint Inc. Kenda® is a registered trademark of Kenda Rubber Industrial Co. Ltd. Ride Designs® and Corbac® are registered trademarks of Aspen Seating, LLC. ROHO®, Low Profile® and Quadtro Select® are registered trademarks of ROHO Inc. Schwalbe® is a registered trademark of Ralf Bohle GmbH. Supracor®, Stimulite® and Corbee® are registered trademarks of Supracor, Inc. The Natural-Fit® and Out-Front® are registered trademarks of Three Rivers Holdings, LLC. Varilite® is a registered trademark of Cascade Designs, Inc.

## NOTES

---

---

---

---

## QUOTE THIS CHAIR

If you are using Adobe Acrobat, this order form may be converted into a quote request or into an order by clicking one of the buttons (this feature is available exclusively to TiLite dealers and distributors). A TiLite Quote or a TiLite Order Confirmation will be sent to you within 24 hours.

## ORDER THIS CHAIR