

TiLite Z SERIES Order Form

Effective March 14, 2016 (New Items in Red)

MONO-TUBE RIGID FRAME

Page 1 of 7

DEALER INFORMATION		RTS INFORMATION	
Dealer:	Account #:	RTS:	Phone:
PO:	Ordered By:	Email:	
Email:		SHIP TO INFORMATION	
Mark For:		Name:	Ship Via:
TiLite Sales Rep:		Address:	
TiLite Information:	Promo Code:	City:	State: Zip:
Ship Date:	Order #:	Phone:	Fax:

Please Email or Fax to the TiLite Customer Service Team at orders@tilite.com or 866.586.2413 / 509.586.2413

FRAME STYLE

- AZFS1 ☐ **Aero Z Aluminum Frame** (Full Adjustability. 265 Pound Weight Limit. Weight Limit is restricted to 150 pounds on chairs with Rear Seat Width **A** and Seat Depth **B** from 10"x10" to 12"x12".).....\$2,500 K0005
- Z2FS2 ☐ **ZRA Titanium Frame Upgrade** (Full Adjustability. 265 Pound Weight Limit. Weight Limit is restricted to 150 pounds on chairs with Rear Seat Width **A** and Seat Depth **B** from 10"x10" to 12"x12".).....\$690 K0108
- Z2FS1 ☐ **ZR Titanium Frame Ultimate TiFIT Upgrade** (ZRA Titanium Frame Upgrade required. Minimal Adjustability. 265 Pound Weight Limit. Weight Limit is restricted to 150 pounds on chairs with Rear Seat Width **A** and Seat Depth **B** from 10"x10" to 12"x12".).....\$410 K0108

TiLite Special Editions If selecting one of the TiLite Special Edition Upgraded Component Packages, you must still fill out the entire order form. Edition options will override inconsistent selections. Options cannot be added or deleted.

ZP1 ☐ SuperLite Edition

- Z2FTR1 Titanium Footrest w/Flat ABS Cover.....\$185
- OR**
- ZFTR2 Titanium Open Loop Footrest.....\$240
- Z2SB2 Folding Titanium Backrest.....\$240
- Z2SB7 Carbon Fiber TiShaft™ Back Release Bar.....\$70
- Z2CBR6 Carbon Fiber Camber Tube (Not available with a Power Adaptable Frame. When a Power Adaptable Frame is selected, an Aluminum Camber Tube will be used.).....\$182
- Z2FK2 TiLite Slipstream Single-Sided Fork.....\$160
- Z2TFS1 Titanium Fork Stem.....\$55

Retail: \$874 - \$947

SuperLite Edition Price: \$810

- ZP5 ☐ **Black Edition** (Black Edition includes: Black Lava Frame Color, Black Anodize Package, LiteSpeed Front Wheels (Must Choose Front Wheel Size on Page 5, Carbon Fiber TiShaft™ Back Release Bar and TiLite Slipstream Single-Sided Fork.)\$1,020

Exclusive To The Black Edition

- ☐ Black on Black Tattoo

Black Lava Footrest

Carbon Fiber Backrest Stripe with Black TiLite Logo

Stainless Quick Release Axles with Black TiLite Tattoo



- ZHDR1 ☐ **Heavy Duty Frame** (300 Pound Weight Limit. No charge when 20" Rear Seat Width **A** and 20" Seat Depth **B** are selected. Includes Tension Adjustable by Straps Back Upholstery. Requires Angle Adjustable Footrest, Folding Aluminum Adjustable Height Backrest, Aluminum Front Wheels, Shadow or Spinergy Spox. LX Rear Wheels only available with 0 or 2 degree camber. Not available with Aero Z, SuperLite Edition, Carbon Fiber Camber Tube, Slipstream Fork, Velcro Adjustable Upholstery, Swing Away Tubular Armrest or Swing Away Flip Back Tubular Armrest.).....\$410

- ZPWR1 ☐ **Power Adaptable Frame for Frank Mobility System** (No charge when 20" Rear Seat Width **A** and 20" Seat Depth **B** are selected. Requires LiteSpeed Billet Aluminum Front Wheels and 0 degree camber. Not available with Single-sided forks, Carbon Fiber or Titanium Camber Tubes, or Slipstream Forks.).....\$320

- ZRFR1 ☐ **Reinforced Frame** (No charge when Heavy Duty Frame or 20" Rear Seat Width **A** and 20" Seat Depth **B** are selected.) ...\$320

TRANSIT OPTION

(Please refer to the **ZRA Transit Tie-Down Option Brochure** for important information regarding the Transit Tie-Down Option. Not available with ZR.)

- ZTTDO3 ☐ **Transit Tie-Down** (Consists of four Tie-Down Brackets, two Pelvic Belt Mounting Brackets and Reinforced Frame.).....\$325

(Please refer to the **ZR Transport Brackets Supplement** for important information regarding the Transit Options. Not available with Aero Z or ZRA.)

- ZWTB ☐ **Transport Bracket Option** (Consists of four Tie-Down Brackets. Unoccupied Use Only.).....\$325

FRAME FINISHES

- ZFF26 ☐ **Light Satin** (Available with Aluminum Frame only. Finished with clear powder coat.)STD

- ZFF1 ☐ **Satin**STD

- ZSCBT1 ☐ **Satin Finish Buffing Pads**.....\$15

- ZFF2 ☐ **Polished**\$695

- ZFF3 ☐ **Tattooed Titanium™** (Tattoos on front frame tubes. Frame finished in Satin. Click on the images below to view the Tattoos online.).....\$315

- ZFF31 ☐ **The King of Rock**

- ZFF32 ☐ **Aloha**



TFF33 ☐ **Snow Leopard**



TFF34 ☐ **Wood Grain**



tilite.com
2701 West Court Street | Pasco, Washington 99301
509.586.6117 Tel | 800.545.2266 Toll-Free
509.586.2413 Fax | 866.586.2413 Toll-Free Fax

TiLite® OF0030_Z_Series_0316RevB

FRAME FINISHES

High Gloss Paint	ZFF8 <input type="checkbox"/> Super Wet Black	ZFF10 <input type="checkbox"/> TiLite Red	ZFF29 <input type="checkbox"/> Neon Pink
	ZFF35 <input type="checkbox"/> Burgundy		
Metallic Paint	ZFF14 <input type="checkbox"/> Ocean Blue Metallic	ZFF15 <input type="checkbox"/> Tangerine Metallic	ZFF16 <input type="checkbox"/> Salsa Red Metallic
	ZFF30 <input type="checkbox"/> Acid Green Metallic		
Pearlescent Paint	ZFF17 <input type="checkbox"/> Midnight Blue Pearl	ZFF18 <input type="checkbox"/> White Pearl	
Matte Paint	ZFF19 <input type="checkbox"/> Black Lava	ZFF20 <input type="checkbox"/> Deep Blue Ice	ZFF27 <input type="checkbox"/> Titanium Grey
Candy Paint	ZFF22 <input type="checkbox"/> Ruby Red	ZFF23 <input type="checkbox"/> Azure Blue	ZFF25 <input type="checkbox"/> Electric PlumSTD

COLOR ANODIZE PACKAGE

(Color Anodize Package includes: Aluminum Camber Tube (Color Anodize not available with Power Adaptable Camber Tube), Camber Mount, Footrest Clamp, Caster Mount, Caster Fork, and Caster Cap. If no anodize color is selected, the default will be black.)

ZANO1 <input type="checkbox"/> Black.....	STD
ZANO5 <input type="checkbox"/> Sapphire ZANO3 <input type="checkbox"/> Red Pepper ZANO6 <input type="checkbox"/> Burnt Orange	
ZANO8 <input type="checkbox"/> Ultraviolet ZANO9 <input type="checkbox"/> Fuschia.....	\$160

TIFIT®: TAILORED INDIVIDUALIZED FRAME

REAR SEAT WIDTH A Measure from outside of seat tube at back post to the outside of the opposite seat tube at back post.

ZSW1 <input type="checkbox"/> 10" <input type="checkbox"/> 11" <input type="checkbox"/> 12" <input type="checkbox"/> 13" <input type="checkbox"/> 14" <input type="checkbox"/> 15" <input type="checkbox"/> 16" <input type="checkbox"/> 17" <input type="checkbox"/> 18" <input type="checkbox"/> 19".....	STD
ZSW2 <input type="checkbox"/> 20".....	\$465 E2201

FRONT SEAT WIDTH (SEAT TAPER) B Measure from inside of front frame tube to inside of opposite front frame tube. (Required with V-Front End **U**. Not Available with Standard Front End **U**.)

ZFSW1 <input type="checkbox"/> No Taper (2.5" Narrower than Rear Seat Width A .).....	STD
ZFSW3 <input type="checkbox"/> 1.5" Taper (4" Narrower than Rear Seat Width A . Includes Tension Adjustable by Straps Seat Upholstery. Not available with 10" and 11" Seat Widths A .).....	\$260
ZFSW5 <input type="checkbox"/> 2.5" Taper (5" Narrower than Rear Seat Width A . Includes Tension Adjustable by Straps Seat Upholstery. Not available with 10" to 14" Seat Widths A .).....	\$260

SEAT DEPTH C Measure from front of back post to the front edge of seat sling. Front edge of seat sling will be at the beginning of the bend at front of chair frame, unless Glide™ or 90° Front Angle is ordered, in which case front edge of seat sling begins approximately 1" behind the bend.

ZSD1 <input type="checkbox"/> 10" <input type="checkbox"/> 11" <input type="checkbox"/> 12" <input type="checkbox"/> 13" <input type="checkbox"/> 14" <input type="checkbox"/> 15" <input type="checkbox"/> 16" <input type="checkbox"/> 17" <input type="checkbox"/> 18" <input type="checkbox"/> 19".....	STD
ZSD2 <input type="checkbox"/> 20".....	\$490 E2203
ZSD3 <input type="checkbox"/> Custom Frame Depth: _____" Frame Depth Longer or Shorter Than Seat Depth D (A Custom Frame Depth of 20" is \$475.).....	NCO

ERGONOMIC SEAT Measure from front of back post to beginning of upward bend of seat tube. See Ergonomic Seat diagram on Page 2. (Not available with Aero Z, ZRA, Tension Adjustable Bolt On Seat Upholstery or G10 Solid Seat.)

ZERG1 <input type="checkbox"/> 4" <input type="checkbox"/> 5" <input type="checkbox"/> 6" <input type="checkbox"/> 7" <input type="checkbox"/> 8" <input type="checkbox"/> 9" <input type="checkbox"/> 10"	\$320
--	-------

FRONT SEAT HEIGHT E Measure from floor to top of seat tube at front of seat sling. ZRA adjusts up and down in 1/2" increments.

ZFSH1 <input type="checkbox"/> 16" <input type="checkbox"/> 16.5" <input type="checkbox"/> 17" <input type="checkbox"/> 17.5" <input type="checkbox"/> 18" <input type="checkbox"/> 18.5" <input type="checkbox"/> 19" <input type="checkbox"/> 19.5" <input type="checkbox"/> 20" <input type="checkbox"/> 20.5" <input type="checkbox"/> 21".....	STD
---	-----

REAR SEAT HEIGHT D Measure from floor to top of seat tube at back post. ZRA adjusts up and down in 1/2" increments.

REAR SEAT HEIGHT RANGES

Rear Wheel Size	ZRA Rear Seat Heights D				
20"	12.5" - 18.5"				
22"	14.0" - 19"	ZRSH1 <input type="checkbox"/> 12.5"	<input type="checkbox"/> 13"	<input type="checkbox"/> 13.5"	<input type="checkbox"/> 14"
24"	14.5" - 20"	<input type="checkbox"/> 14.5"	<input type="checkbox"/> 15"	<input type="checkbox"/> 15.5"	<input type="checkbox"/> 16"
25"	14.5" - 20"	<input type="checkbox"/> 16.5"	<input type="checkbox"/> 17"	<input type="checkbox"/> 17.5"	<input type="checkbox"/> 18"
26"	15.5" - 20"	<input type="checkbox"/> 18.5"	<input type="checkbox"/> 19"	<input type="checkbox"/> 19.5"	<input type="checkbox"/> 20".....STD

FRONT ANGLE I Measure from frame front to floor.

ZFA1 <input type="checkbox"/> 70° <input type="checkbox"/> 75° <input type="checkbox"/> 80° <input type="checkbox"/> 85° (85° Not available with 6" Front Wheels.)	
<input type="checkbox"/> 90° (90° Not available with 5" or 6" Front Wheels.)	STD

SEAT TO FOOTREST B/FOOTRESTS Measure from front edge of seat sling to top rear of footrest.

Standard Footrests Measurement must be at least 2" shorter than Front Seat Height **E**.

<input type="checkbox"/> 13.5" <input type="checkbox"/> 14" <input type="checkbox"/> 14.5" <input type="checkbox"/> 15" <input type="checkbox"/> 15.5" <input type="checkbox"/> 16" <input type="checkbox"/> 16.5" <input type="checkbox"/> 17" <input type="checkbox"/> 17.5" <input type="checkbox"/> 18" <input type="checkbox"/> 18.5" <input type="checkbox"/> 19"	
ZFTR3 <input type="checkbox"/> Angle Adjustable Footrest	STD
ZFTR1 <input type="checkbox"/> Titanium Footrest w/Flat ABS Cover (Not available with Heavy Duty Frame.).....	\$185
ZFTR2 <input type="checkbox"/> Titanium Open Loop Footrest (Not available with Heavy Duty Frame.).....	\$240
ZFTR12 <input type="checkbox"/> Flip-Back Footrest (Not available with 10" or 11" Rear Seat Width A , Heavy Duty Frame, ABS Cover with 2" Sides or Front Roller.).....	\$210 K0040, K0045

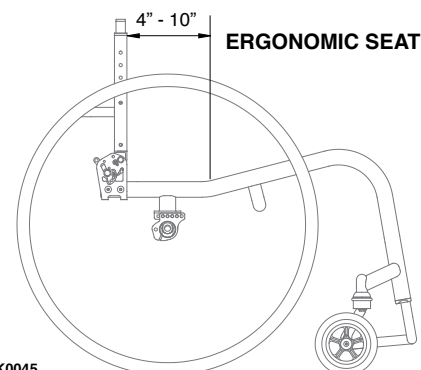
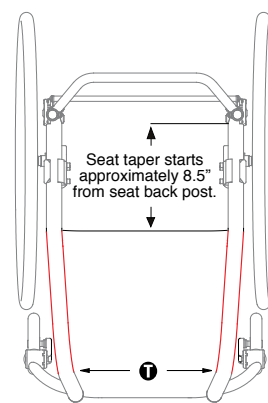
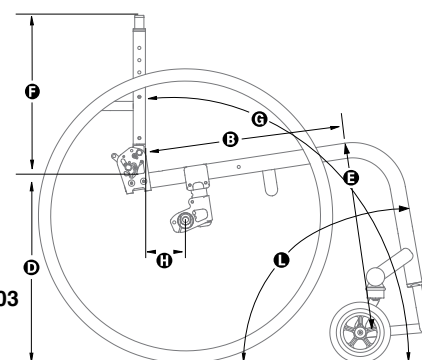
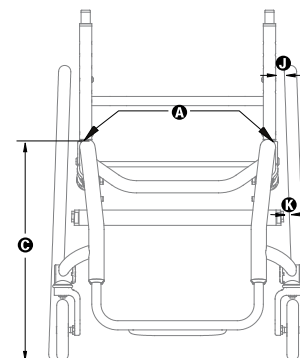

TIFIT®: TAILORED INDIVIDUALIZED FRAME

High Mount Footrests

☐ 7"-9" ☐ 9"-11" ☐ 11"-13" Set at: _____ (Use 1/2" increments)

ZFTR4 ☐ Angle Adjustable High Mount Footrest.....\$90 K0040

ZFTR14 ☐ ABS Cover w/2" Sides (Not available with Flip-Back Footrest or chairs with 10" or 11" Rear Seat Width A.).....\$100 K0041

FOOTREST WIDTH ① or ② You must select a V-Front End if a Seat Taper ① is selected on Page 2.

ZFE1 **STANDARD FRONT END ①** Find your Rear Seat Width A in the Chart below and select one of the options to the right.

Measure from inside of front frame tube to inside of opposite front frame tube. (Not Available with Front Seat Width (Seat Taper) ①.).....STD

REAR SEAT WIDTH A (Outside Measurement)	FOOTREST WIDTH ①		
	No Taper (2.5" Narrower than Rear Seat Width)	1.5" Taper (4" Narrower than Rear Seat Width)	3.5" Taper (6" Narrower than Rear Seat Width)
10"	<input type="checkbox"/> 7.5"		
11"	<input type="checkbox"/> 8.5"		
12"	<input type="checkbox"/> 9.5"	<input type="checkbox"/> 8"	
13"	<input type="checkbox"/> 10.5"	<input type="checkbox"/> 9"	
14"	<input type="checkbox"/> 11.5"	<input type="checkbox"/> 10"	
15"	<input type="checkbox"/> 12.5"	<input type="checkbox"/> 11"	<input type="checkbox"/> 9"
16"	<input type="checkbox"/> 13.5"	<input type="checkbox"/> 12"	<input type="checkbox"/> 10"
17"	<input type="checkbox"/> 14.5"	<input type="checkbox"/> 13"	<input type="checkbox"/> 11"
18"	<input type="checkbox"/> 15.5"	<input type="checkbox"/> 14"	<input type="checkbox"/> 12"
19"	<input type="checkbox"/> 16.5"	<input type="checkbox"/> 15"	<input type="checkbox"/> 13"
20"	<input type="checkbox"/> 17.5"	<input type="checkbox"/> 16"	<input type="checkbox"/> 14"

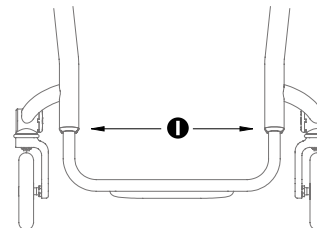

ZFE1 ☐ **NO V-Front Taper** (Required when both Heavy Duty Frame and Seat Taper ① are selected.).....NCO

OR

ZFE2 **V-FRONT END ②** Measure from inside of front frame tube to inside of opposite front frame tube 2-1/2" above

footrest. (Required with Front Seat Taper ①. Titanium Footrests have 1" of adjustment up and down.).....\$270

<input type="checkbox"/> 7"	<input type="checkbox"/> 7.5"	<input type="checkbox"/> 8"	<input type="checkbox"/> 8.5"	<input type="checkbox"/> 9"	<input type="checkbox"/> 9.5"
<input type="checkbox"/> 10"	<input type="checkbox"/> 10.5"	<input type="checkbox"/> 11"	<input type="checkbox"/> 11.5"	<input type="checkbox"/> 12"	<input type="checkbox"/> 12.5"
<input type="checkbox"/> 13"	<input type="checkbox"/> 13.5"	<input type="checkbox"/> 14"	<input type="checkbox"/> 14.5"	<input type="checkbox"/> 15"	<input type="checkbox"/> 15.5"
<input type="checkbox"/> 16"	<input type="checkbox"/> 16.5"	<input type="checkbox"/> 17"			

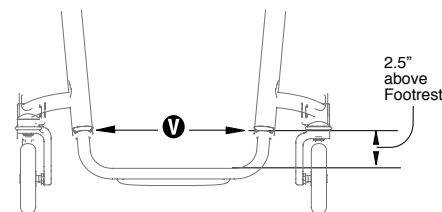

SEAT BACK TYPE/PUSH HANDLES/SEAT BACK HEIGHT ③ Measure from top of back post to top of seat tube at rear of frame.

SEAT BACK TYPE

ZSB1 ☐ Folding Aluminum Adjustable Height (Required for Heavy Duty Frame.).....NCO

ZSB2 ☐ Folding Titanium Adjustable Height with New Rounded Rigidizer Bar (Titanium back will match Frame Finish.

Not available with Bolt-On Push Handles.).....\$240

ZSB15 ☐ Non-Folding, Fixed Height Titanium with New Rounded Rigidizer Bar (Not available with Aero Z, ZRA,

Transport Brackets. Titanium back will match Frame Finish.).....\$265

TISHAFT™ BACK RELEASE BARS

ZSB3 ☐ Aluminum.....STD

ZSB4 ☐ Titanium.....\$70

ZSB5 ☐ Carbon Fiber.....\$70

PUSH HANDLES

ZSB6 ☐ Integrated Push HandlesNCO

ZSB7 ☐ Integrated Fold-Down Push Handles (Requires Tension Adjustable by Straps Back Upholstery.)\$105

ZSB8 ☐ Bolt-On Push Handles (Includes 4" Deep Backrest Rigidizer Bar. Not available with Ti Back.).....\$185

ZSB9 ☐ Bolt-On Height-Adjustable Push Handles (Includes 4" Deep Backrest Rigidizer Bar. Not available with Ti Back.).....\$315

SEAT BACK HEIGHT ③

FOLDING BACKREST

Push Handles (Selected Above)	Short	Medium	Tall	Set at: (Use 1/2" increments)
None / Bolt-On	<input type="checkbox"/> 8.5"- 11.5"	<input type="checkbox"/> 12"- 16.5"	<input type="checkbox"/> 16.5"- 20.5"	Set at: _____
Integrated	<input type="checkbox"/> 10.5"- 12.5"	<input type="checkbox"/> 13.5"- 16.5"	<input type="checkbox"/> 17.5"- 20.5"	Set at: _____
Integrated Fold-Down	<input type="checkbox"/> 13"- 15"	<input type="checkbox"/> 14.5"- 18.5"	<input type="checkbox"/> 18.5"- 21"	Set at: _____

ZSB15 **NON-FOLDING, FIXED-HEIGHT TITANIUM SEAT BACK** (Titanium back will match Frame Finish. Required for Fixed Side Guards. Not available with Aero Z, ZRA, Swing Away Tubular, Swing Away - Flip Back Tubular Armrests and Integrated Push Handles, Integrated Fold-Down Push Handles or Bolt-On Height Adjustable Push Handles.)

<input type="checkbox"/> 8"	<input type="checkbox"/> 8.5"	<input type="checkbox"/> 9"	<input type="checkbox"/> 9.5"	<input type="checkbox"/> 10"	<input type="checkbox"/> 10.5"	<input type="checkbox"/> 11"	<input type="checkbox"/> 11.5"	<input type="checkbox"/> 12"	<input type="checkbox"/> 12.5"	<input type="checkbox"/> 13"	<input type="checkbox"/> 13.5"	<input type="checkbox"/> 14"	<input type="checkbox"/> 14.5"
<input type="checkbox"/> 15"	<input type="checkbox"/> 15.5"	<input type="checkbox"/> 16"	<input type="checkbox"/> 16.5"	<input type="checkbox"/> 17"	<input type="checkbox"/> 17.5"	<input type="checkbox"/> 18"	<input type="checkbox"/> 18.5"	<input type="checkbox"/> 19"	<input type="checkbox"/> 19.5"	<input type="checkbox"/> 20"			

TIFIT®: TAILORED INDIVIDUALIZED FRAME

AVAILABLE ON ALL BACKS

- ZSB11 ☐ Seat Back that Locks when Folded.....**NCO**
- ZSB12 ☐ 4" Deep Backrest Rigidizer Bar (Required for Heavy Duty Frame. Available with Aluminum and Titanium backrest option. Not available with a Non-Folding, Fixed Height Titanium Seat Back type. 4" Deep Rigidizer Bar is NOT a rounded style rigidizer bar.).....**NCO**
- ZSB16 ☐ Depth Adjustable Back/Frame (Seat Depths **ⓐ** of 10"-18" allow 2" of rearward adjustment. Height Adjustable Push Handles have a limited Height range with Depth Adjustable Back. Not Available with 19" or 20" Seat Depths **ⓐ**, Heavy Duty Edition, Tension Adjustable by Straps Seat Upholstery or Carbon Fiber Side Guards).....**NCO**
- ZSB13 ☐ Custom Height Backrest Rigidizer Bar (The Standard Rigidizer Bar height is 5" above the Seat Sling for a short, 6" for a medium and 10" for a tall. Custom Height Rigidizer Bar must be at least 4-1/2" above Seat Sling. Maximum Height is 3" less than Lowest Seat Back Height without push handles.).....**\$160**
Set at: _____ (Use 1/4" increments)

SEAT BACK ANGLE **ⓐ** Measure angle from front of back post to floor.

- ZBA1 ☐ **Folding Back**
☐ 80° ☐ 83° ☐ 86° ☐ 89° ☐ 92° ☐ 95° ☐ 98° ☐ 101°.....**NCO**
- ZBA1 ☐ **Non-Folding Back** (Not available with Aero Z and ZRA.)
☐ 80° ☐ 81° ☐ 82° ☐ 83° ☐ 84° ☐ 85° ☐ 86° ☐ 87° ☐ 88° ☐ 89° ☐ 90° ☐ 91°
☐ 92° ☐ 93° ☐ 94° ☐ 95° ☐ 96° ☐ 97° ☐ 98° ☐ 99° ☐ 100° ☐ 101°.....**NCO**

CENTER OF GRAVITY **ⓑ** Measure from front of back post at the seat tube to the center of the rear axle. If no center of gravity is selected, chair will ship with the center of gravity in the rearward-most position.

- ZCOG1 ☐ 0" ☐ .25" ☐ .5" ☐ .75" ☐ 1" ☐ 1.25" ☐ 1.5" ☐ 1.75" ☐ 2" ☐ 2.25" ☐ 2.5" ☐ 2.75"
☐ 3" ☐ 3.25" ☐ 3.5" ☐ 3.75" ☐ 4" ☐ 4.25" ☐ 4.5" ☐ 4.75" ☐ 5" ☐ 5.25" ☐ 5.5" ☐ 5.75"
☐ 6".....**STD**

CAMBER **ⓐ**/CAMBER TUBES

- ZCBR1 ☐ 0° ☐ 2° ☐ 4° ☐ 6° ☐ 8° ☐ 12° (More than 0° of Camber **ⓐ** is not available with the Power Adaptable Frame. More than 6° of Camber **ⓐ** is not available with Zero Play Aluminum Camber Plugs or Carbon Fiber Camber Tube.).....**STD**
- ZCBR15 ☐ Aluminum Camber Tube.....**STD**
- ZCBR3 ☐ Titanium Camber Tube (Not available with Power Adaptable Frame.).....**\$185**
- ZCBR6 ☐ Carbon Fiber Camber Tube (Not available with Power Adaptable Frame or more than 6° of Camber **ⓐ**.).....**\$185**

REAR WHEEL SPACING **ⓑ** /PLUGS Measure from outside of seat back post to inside of rear tire. 3/4" Rear Wheel Spacing not available with 0° or 2° Camber **ⓐ**.

- ZRWS1 ☐ .75" ☐ 1" ☐ 1.25" ☐ 1.5" ☐ 1.75" ☐ 2".....**STD**
- ZCBR12 ☐ Adjustable Rear Wheel Spacing Camber Plugs (Not available with Power Adaptable Frame.).....**STD**
- ZCBR9 ☐ Additional Spacers to Increase Rear Wheel Spacing.....**NCO**
- ZCBR11 ☐ Zero Play Aluminum Camber Plugs (Not available with more than 6° of Camber **ⓐ** or Power Adaptable Frame.).....**NCO**

CUSTOM CONFIGURATION OPTIONS

FRONT WHEELS

- ZFW24 ☐ 3"x1.5" LiteSpeed Billet Aluminum Wheel w/Soft Roll Tire ☐ Silver Hub **OR** ☐ Black Hub**\$175**
- ZFW14 ☐ 4"x.75" Plastic Wheel w/Poly Tire (Not available with Slipstream Fork, Glide™ Single-Sided Fork, Heavy Duty or Power Adaptable Frame.).....**NCO**
- ZFW3 ☐ 4"x.75" Light-Up Micro-Caster (Not available with Slipstream Fork, Glide™ Single-Sided Fork, Heavy Duty or Power Adaptable Frame.).....**\$75**
- ZFW25 ☐ 4"x.75" LiteSpeed Billet Aluminum Wheel w/Poly Tire ☐ Silver Hub **OR** ☐ Black Hub.....**\$135**
- ZFW26 ☐ 4"x1.5" LiteSpeed Plastic Wheel w/Soft Roll Tire (Not available with Power Assist, Power Add-on System or Heavy Duty Frame.).....**\$85**
- ZFW27 ☐ 4"x1.5" LiteSpeed Billet Aluminum Wheel w/Soft Roll Tire ☐ Silver Hub **OR** ☐ Black Hub.....**\$185**
- ZFW6 ☐ 5"x1" Plastic Wheel w/Poly Tire (Not available with 90° Front Angle **ⓑ**, Slipstream Fork, Glide™ Single-Sided Fork, Heavy Duty or Power Adaptable Frame.).....**NCO**
- ZFW28 ☐ 5"x1.5" LiteSpeed Plastic Wheel w/Soft Roll Tire (Not available with Heavy Duty, Power Adaptable Frame, or 90° Front Angle **ⓑ**.).....**\$85**
- ZFW29 ☐ 5"x.75" LiteSpeed Billet Aluminum Wheel w/Poly Tire ☐ Silver Hub **OR** ☐ Black Hub (Not available with 90° Front Angle **ⓑ**.).....**\$155**
- ZFW30 ☐ 5"x1.5" LiteSpeed Billet Aluminum Wheel w/Soft Roll Tire ☐ Silver Hub **OR** ☐ Black Hub (Not available with 90° Front Angle **ⓑ**.).....**\$200**
- ZFW9 ☐ 6"x1" Plastic Wheel w/Poly Tire (Not available with Heavy Duty, Power Adaptable Frame or 85° or 90° Front Angle **ⓑ**, Glide™ Single-Sided Fork or Slipstream Fork.).....**NCO**
- ZFW34 ☐ 6"x1" LiteSpeed Billet Aluminum Wheel w/Poly Tire ☐ Silver Hub **OR** ☐ Black Hub (Not available with 85° or 90° Front Angle **ⓑ**, Glide™ Single-Sided Fork or Slipstream Fork.).....**\$175**
- ZFW32 ☐ 6"x1.5" LiteSpeed Plastic Wheel w/Soft Roll Tire (Not available with Heavy Duty, Power Adaptable Frame or 85° or 90° Front Angle **ⓑ**, Glide™ Single-Sided Fork or Slipstream Fork.).....**\$90**
- ZFW33 ☐ 6"x1.5" LiteSpeed Billet Aluminum Wheel w/Soft Roll Tire ☐ Silver Hub **OR** ☐ Black Hub (Not available with 85° or 90° Front Angle **ⓑ**, Glide™ Single-Sided Fork or Slipstream Fork.).....**\$210**

FRONT FORKS

- ZFK1 ☐ TiLite Standard Fork.....**STD**
- ZFK2 ☐ TiLite Slipstream Single-Sided Fork (Not available with Heavy Duty Frame or Power Adaptable Frame.).....**\$160**
- ZGL1 ☐ Out-Front Glide™ Suspension Fork (Black anodize only. Not available with Heavy Duty Frame).....**\$455** **E1015**
Rider's Weight: ☐ 125 lbs. ☐ 125-180 lbs. ☐ 180-265 lbs.
- ZGL2 ☐ Out-Front Glide™ Single-Sided Suspension Fork (Black anodize only. Not available with 6" Front Wheels or Heavy Duty Frame).....**\$585** **E1015**
Rider's Weight: ☐ 125 lbs. ☐ 125-180 lbs. ☐ 180-265 lbs.
- ZTFS1 ☐ Titanium Fork Stem.....**\$55**

CUSTOM CONFIGURATION OPTIONS

STANDARD REAR WHEELS (See Rear Seat Height Ranges Chart on Page 3 for Rear Seat Height ⑨ limitations.)

ZRW14 TiLite SHADOW™	STD
<input type="checkbox"/> 20"(451)		
<input type="checkbox"/> 22"(501)		
<input type="checkbox"/> 24"(540)		
<input type="checkbox"/> 25"(559) (Requires 15" minimum Seat Depth ⑨.)		
<input type="checkbox"/> 26"(590) (Requires 15" minimum Seat Depth ⑨.)		

PERFORMANCE REAR WHEELS (See Rear Seat Height Ranges Chart on Page 3 for Rear Seat Height ⑨ limitations.)

ZRW7 Spinergy SPOX <input type="checkbox"/> Black <input type="checkbox"/> Red <input type="checkbox"/> Yellow <input type="checkbox"/> Blue <input type="checkbox"/> White	\$795
<input type="checkbox"/> 22"(501) - Std. Hub		
<input type="checkbox"/> 24"(540) - Std. Hub		
<input type="checkbox"/> 25"(559) - Std. Hub (Requires 15" minimum Seat Depth ⑨.)		
<input type="checkbox"/> 26"(590) - Sport Hub (Requires 15" minimum Seat Depth ⑨. Not available with Quad Release Axles.)		
ZRW8 Spinergy LX <input type="checkbox"/> Black <input type="checkbox"/> Red <input type="checkbox"/> Yellow <input type="checkbox"/> Blue <input type="checkbox"/> White <input type="checkbox"/> Go Green <input type="checkbox"/> Bright Orange <input type="checkbox"/> Flamingo Pink	\$995
<input type="checkbox"/> 22"(501) - Std. Hub		
<input type="checkbox"/> 24"(540) - Std. Hub		
<input type="checkbox"/> 25"(559) - Std. Hub (Requires 15" minimum Seat Depth ⑨.)		
<input type="checkbox"/> 26"(590) - Sport Hub (Requires 15" minimum Seat Depth ⑨. Not available with Quad Release Axles.)		
ZRW16 Spinergy Carbon Blade (Not available with Heavy Duty Frame.)	\$1,395
<input type="checkbox"/> 24"(540)		
<input type="checkbox"/> 25"(559) (Requires 15" minimum Seat Depth ⑨.)		
ZRW17 X-Core Mag (Not available with Heavy Duty Frame, Short Tabs, Quad Release Axles or Spoke Guards. Available with Aluminum Sliver Anodized Handrims only.)	\$55
<input type="checkbox"/> 20"(451)		
<input type="checkbox"/> 22"(501)		
<input type="checkbox"/> 24"(540)		

AXLES

ZAXL1 <input type="checkbox"/> Stainless Quick Release	STD
ZAXL2 <input type="checkbox"/> Titanium Quick Release	\$240
ZAXL3 <input type="checkbox"/> Quad Release (Not available with Mag or 26"(590) Spinergy Spox or LX Rear Wheels.)	\$145

PNEUMATIC REAR TIRES

ZRTR1 <input type="checkbox"/> Treaded (Not available with 25"(559) Rear Wheels. 20" (451) Mag Wheels require Airless Inserts.)	STD
Z2RTR2 <input type="checkbox"/> Airless Inserts (Not available with Topolino Rear Wheels.)	\$85 E2213
ZRTR3 <input type="checkbox"/> 25"(559) Primo Treaded (Standard with 25"(559) Rear Wheels.)	STD
ZRTR4 <input type="checkbox"/> Primo (Not available with Mag Rear Wheels.)	NCO
ZRTR8 <input type="checkbox"/> 24"(540), 25"(559) and 26"(590) Schwalbe® Marathon Plus Evolution (Not available with Mag Rear Wheels.)	\$130
ZRTR9 <input type="checkbox"/> 24"(540) and 25"(559) Schwalbe® Slick Tires (Not available with Mag Rear Wheels.)	\$135
ZRTR24 <input type="checkbox"/> 24" Kenda Kobra Knobby Tires	\$80

SOLID REAR TIRES

ZRTR22 <input type="checkbox"/> 20"(451), 22"(501), and 24"(540) Primo Express	\$100
ZRTR23 <input type="checkbox"/> 24"(540) and 25"(559) Primo Active	\$125

HANDRIMS

Handrims by OUT-FRONT®

ZRIM1 <input type="checkbox"/> Aluminum – Silver Anodized	STD
ZRIM21 <input type="checkbox"/> Aluminum – Black Anodized (Not available with Mag or 20"(451) Rear Wheels.)	NCO
ZRIM12 <input type="checkbox"/> Titanium – Satin Finish (Not available with Mag, 20"(451) or 22"(501) Rear Wheels, or 24"(540) Knobby tires.)	\$430
The Natural-Fit® (Original, Larger Profile) (Not available with Mag or 20"(451) Rear Wheels.)		
ZRIM14 <input type="checkbox"/> Standard Grip (Not available with Short Tabs or Spinergy Carbon Blade Rear Wheels.)	\$360
ZRIM15 <input type="checkbox"/> Super Grip (Not available with Short Tabs or Spinergy Carbon Blade Rear Wheels.)	\$405
ZRIM16 <input type="checkbox"/> Without Thumb Grip	\$335
The Natural-Fit® LT (Reduced Weight, Smaller Profile) (Not available with Mag or 20"(451) Rear Wheels.)		
ZRIM17 <input type="checkbox"/> Standard Grip (Not available with Short Tabs or Spinergy Carbon Blade Rear Wheels.)	\$390
ZRIM18 <input type="checkbox"/> Super Grip (Not available with Short Tabs or Spinergy Carbon Blade Rear Wheels.)	\$440
ZRIM19 <input type="checkbox"/> Without Thumb Grip	\$365
ZRIM10 <input type="checkbox"/> The Surge (All-In-One Oval with Gription™ Strip, Larger Profile) (Not available with Mag or 20"(451) Rear Wheels.)	\$375
ZRIM11 <input type="checkbox"/> The Surge LT (All-In-One Oval with Gription™ Strip, Smaller Profile) (Not available with Mag or 20"(451) Rear Wheels.)	\$405
ZRIM20 <input type="checkbox"/> Q-Grip (Exclusive High-Friction, Anti-Slip Coating) (Not available with 20"(451) or Mag Rear Wheels.)	\$315
ZRIM21 <input type="checkbox"/> Omit Handrims	NCO

Tab Length

ZRIM7 <input type="checkbox"/> Long Tabs	STD
ZRIM8 <input type="checkbox"/> Short Tabs (Not available with Mag Rear Wheels or The Natural-Fit® Handrims with Thumb Grip.)	\$20

WHEEL LOCKS

Wheel Locks by OUT-FRONT®

ZWLK7 <input type="checkbox"/> Compact Composite Push to Lock (Available with .75" to 1.5" Rear Wheel Spacing ① only)	NCO
ZWLK8 <input type="checkbox"/> Compact Composite Pull to Lock (Available with .75" to 1.5" Rear Wheel Spacing ① only)	NCO
Z2WLK10 <input type="checkbox"/> Extension Handles for Compact Composite Push/Pull to Lock	\$80 E0961
ZWLK9 <input type="checkbox"/> Composite Scissor Lock	\$135

CUSTOM CONFIGURATION OPTIONS

Additional Wheel Locks

- ZWLK3 Uni-Lock Set At: ☐ Push **OR** ☐ Pull.....\$155
- ZWLK4 ☐ Extension Handles for Uni-Lock.....\$80 E0961

BACK UPHOLSTERY (Want more seating options? [Click here](#) to view the new TiLite Seating Order Form.)

- ZBUP2 ☐ Velcro Adjustable (Not available with Fold-Down Push Handles.).....STD
- Tension Adjustable by Straps (Required with Fold-Down Push Handles.)
- ZBUP3 ☐ Padded Nylon.....\$320 E2611
- ZBUP5 ☐ AIR Breathable Upholstery (Not available with Ultrasuede or NiteLite Backrest Stripe.).....\$320 E2611
- ZUPC3 Ultrasuede Backrest Stripe ☐ Black ☐ Sapphire ☐ Red Pepper ☐ Burnt Orange ☐ Ultraviolet
- ☐ NiteLite Reflective (Not available with AIR Breathable Back Upholstery.).....\$95
- ZBUP0 ☐ Omit Back Upholstery.....NCO

SEAT UPHOLSTERY

- ZSUP1 ☐ Tension Adjustable Bolt On (Not available with Tapered Seat ①. Black only.).....STD
- Z2SUP7 ☐ iSleeve™ Under Seat Smartphone Holder (Not available with 10" to 13" Rear Seat Width ① or Seat Depth ②.).....NCO
- ZSUP2 ☐ Tension Adjustable by Straps (Standard with Front Seat Width (Seat Taper) ① of 1.5" and 2.5". Not Available with Depth Adjustable Back/Frame. Black only.).....\$160
- ZSUP3 ☐ G10 Solid Seat (Not available with 10" or 11" Rear Seat Width ①.).....\$265 E2231
- ZSUP0 ☐ Omit Seat Upholstery.....NCO

SEAT CUSHION (Want more seating options? [Click here](#) to view the new TiLite Seating Order Form.)

- ZCSH1 Foam Cushion ☐ 2" ☐ 3" ☐ 4".....\$105

SIDE GUARDS

- Z2SDG1 ☐ Cloth (Not available with Ride Designs® Corbac™ back support.).....\$90

Aluminum

- ZSDG2 ☐ Rigid Removable ☐ Small **OR** ☐ Std.....\$185
- ZSDG3 ☐ Quad Removable w/Hole ☐ Small **OR** ☐ Std.....\$200
- ZSDG4 ☐ Fold Down Rigid ☐ Small **OR** ☐ Std.....\$315
- ZSDG6 ☐ Fendered Adjustable (Available with 24" and 25" Rear Wheels. Requires Rear Seat Height ② of 14.5" to 18.5".).....\$315

Carbon Fiber (Not available with Depth Adjustable Back/Frame.)

- ZSDG7 ☐ Rigid Removable ☐ Small **OR** ☐ Std.....\$290
- ZSDG8 ☐ Quad Removable w/Hole ☐ Small **OR** ☐ Std.....\$300
- ZSDG9 ☐ Fold Down Rigid ☐ Small **OR** ☐ Std.....\$430
- ZSDG11 ☐ Fendered Adjustable (Available with 24" and 25" Rear Wheels. Requires Rear Seat Height ② of 14.5" to 18.5".).....\$530
- ZSDG12 ☐ Fendered Removable.....\$425

Available on Aluminum and Carbon Fiber Non-Fendered Side Guards

- ZSDG13 ☐ Side Guards Custom Cut to Profile of Rear Wheels (Not available with Cloth.).....\$295

ARMRESTS (Desk Arms come with built-in Side Guards.)

- ZARM1 Swing Away Tubular ☐ 9" to 12" **OR** ☐ 11" to 14" (Not available with Heavy Duty Frame or Height Adjustable Push Handles.).....\$210 E0973
- ZARM4 ☐ Swing Away - Flip Back Tubular 9" to 12" (Not available with Heavy Duty Frame.).....\$295 E0973
- ZARM2 Removable Height Adjustable Desk Arm with Rigid Side Guard (Not available with ZR upgrade. Requires 14" minimum Seat Depth ②.).....\$315 E0973
- ☐ 9" to 12" **OR** ☐ 12" to 15"
- ☐ Standard Length Pad (10") **OR** ☐ Full Length Pad (14")
- ZARM3 Removable Height Adjustable Desk Arm with Rigid Side Guard and Transfer Loop (Requires 15" minimum Seat Depth ②.).....\$350 E0973
- ☐ 9" to 12" **OR** ☐ 12" to 15"
- ☐ Standard Length Pad (10") **OR** ☐ Full Length Pad (14")

Available Armrest Option

- ZARM5 ☐ Covered in Black Ultrasuede (Not available with Desk Arms).....\$100

SEAT BELTS

- ZBLT1 ☐ Velcro Adjustable, Black Nylon Webbing.....\$50 E0978
- ZBLT2 ☐ Bodypoint® 2" Push-Button Buckle (Auto-Style.).....\$90 E0978
- ZBLT4 ☐ Bodypoint® 1" Wide Push-Button Buckle Padded (Auto-Style.) (Not available with 19" or 20" Rear Seat Widths ①.).....\$175 E0978
- ZBLT5 ☐ Bodypoint® 1.5" Wide Push-Button Buckle Padded (Auto-Style.) (Not available with 19" or 20" Rear Seat Widths ①.).....\$165 E0978
- ZBLT8 ☐ Q'Strain® WC-19 Wheelchair-Anchored Pelvic Belt (Recommended for use with Transit Tie-Down. Not available with ZR).....\$185 E0978
- ZBLT10 ☐ Bodypoint® Optional Band Clamp Mounting Hardware.....\$20 E0978

CALF STRAP

- ZCLF2 Velcro Adjustable.....\$35 K0038
- ☐ Xtra Small (Recommended for 6"- 9" Footrest Widths)
- ☐ Small (Recommended for 9"- 12" Footrest Widths)
- ☐ Medium (Recommended for 11"- 15" Footrest Widths)
- ☐ Large (Recommended for 14"- 17" Footrest Widths)
- ☐ Xtra Large (Recommended for 16"- 19" Footrest Widths)

TiLite Z SERIES Order Form

Effective March 14, 2016 (New Items in Red)

MONO-TUBE RIGID FRAME

Page 7 of 7

CUSTOM CONFIGURATION OPTIONS

ZCLF3 Bodypoint® Padded Velcro Adjustable	\$95	K0038
<input type="checkbox"/> Small (Recommended for 8"- 11" Footrest Widths)		
<input type="checkbox"/> Medium (Recommended for 12"- 15" Footrest Widths)		
<input type="checkbox"/> Large (Recommended for 16"- 20" Footrest Widths)		
ZCLF1 <input type="checkbox"/> Buckle Adjustable, Black Nylon Webbing.....	\$25	K0038

BACK PACK

ZBCK3 <input type="checkbox"/> Black TiLite Back Pack	\$85	
---	------	--

SEAT POUCH

ZPCH3 <input type="checkbox"/> Black TiLite Seat Pouch.....	\$55	
---	------	--

SPOKE GUARDS by SPOZEE.COM

ZGRD1 <input type="checkbox"/> Clear Lexan with TiMotion Logo (Not available with Mag Rear Wheels.).....	\$125	K0065
--	-------	-------

ANTI-TIPS

ZTIP1 <input type="checkbox"/> Rear Aluminum - Black.....	\$150	E0971
ZTIP2 <input type="checkbox"/> User Friendly Flip-up.....	\$315	E0971

ACCESSORIES

ZUEST1 Upper Extremity Support Tray <input type="checkbox"/> 12" to 14" OR <input type="checkbox"/> 13" to 15" Seat Widths A (Requires Armrests.).....	\$270	E0950
ZLUG1 <input type="checkbox"/> Luggage Carriers.....	\$135	
ZGS1 <input type="checkbox"/> GRIP Solutions Lap Board.....	\$50	
ZMPCT2 Neoprene Impact Guards with Ultrasuede Stripe <input type="checkbox"/> Black <input type="checkbox"/> Sapphire <input type="checkbox"/> Red Pepper <input type="checkbox"/> Burnt Orange		
<input type="checkbox"/> Ultraviolet <input type="checkbox"/> TiLite NiteLite Neoprene Impact Guards with Reflective Stripe.....	\$95	
ZCH1 <input type="checkbox"/> Crutch Holder.....	\$210	E2207
ZHS1 <input type="checkbox"/> TiLite 9 Piece SAE Round Handle Folding Hex Key Set.....	\$25	
ZAFP1 4" Logo Patch <input type="checkbox"/> Army <input type="checkbox"/> Navy <input type="checkbox"/> Air Force <input type="checkbox"/> Marines	\$95	

DESIGNS UNLIMITED

TiLite's Z Series offers more than 71 million different frame combinations! But sometimes even that's not enough. If you would like to customize your TiLite, check out the Designs Unlimited Studio at tilite.com. There you will find drawings and pricing for hundreds of creative solutions to customers' customization requests. We call these "D.U.'s." If you don't find the D.U. you're looking for, contact the TiLite Customer Service Team at 800.545.2266 or customerservice@tilite.com and we'll design a D.U. just for you. Designs Unlimited customization may add an additional 2 to 3 weeks to the ship time of your chair.

GENERAL

TiLite manufactures a wide variety of wheelchairs to meet the varied needs of wheelchair users. The final selection of a particular model, its options and accessories, and its measurements rests solely with the wheelchair user and advising healthcare professional. TiLite wheelchairs must be fitted by a qualified healthcare professional. HCPCS Codes are for reference purposes only. Actual coding and coverage varies by payer. Proper HCPCS coding is not a guarantee of payment. Please verify the appropriate payer's coverage policy.

Get the latest order forms at tilite.com. Prices, standard features, options and accessories are subject to change without notice. All rights reserved. Trademarks are identified by symbols™ and ®. TiLite, TiFit, the TiLite logo, Ti, the Ti logo, The Titanium Experts, and TiShaft are registered trademarks of TiSport, LLC and are licensed to TiLite, LLC. Adobe®, Acrobat®, Acrobat Professional® and Reader® are registered trademarks of Adobe Systems Inc. Bodypoint® is a registered trademark of Bodypoint Inc. Kenda® is a registered trademark of Kenda Rubber Industrial Co. Ltd. Ride Designs® and Corbac® are registered trademarks of Aspen Seating, LLC. ROHO®, Low Profile® and Quadtro Select® are registered trademarks of ROHO Inc. Schwalbe® is a registered trademark of Ralf Bohle GmbH. Supracor®, Stimulite® and Corbee® are registered trademarks of Supracor, Inc. The Natural-Fit® and Out-Front® are registered trademarks of Three Rivers Holdings, LLC. Varilite® is a registered trademark of Cascade Designs, Inc. Q'Straint is a registered trademark of Valeda Company, LLC.

QUOTE THIS CHAIR

If you are using Adobe Acrobat, this order form may be converted into a quote request or into an order by clicking one of the buttons (this feature is available exclusively to TiLite dealers and distributors). A TiLite Quote or a TiLite Order Confirmation will be sent to you within 24 hours.

ORDER THIS CHAIR